



The universal oil burner is ideal for numerous different types of oil. No conversion required. Thanks to compressed air atomisation technology. A small oil pump is used to feed oil into the burner tank. A float switch keeps the oil at the correct level inside the tank. An electric oil heater is integrated in the burner tank. The universal oil burners are connected to an external compressed air system. Compressed air passes through the compressed-air atomising nozzle, draws in the oil from the fuel tank by the Venturi principle and atomises it into microscopically small droplets. Depending on capacity, the burner is fitted with one, two or three oil nozzles. The combustion air is comprised of compressed air as primary air and blower air as secondary air. The finely atomised oil mist mixes with the air at the oilfusor air and combusts. The blower air flow is set manually at the air damper. And if your type of oil is not available, you can use standard EL fuel oil. Simply change the air supply and turn the thermostat for tank heating to „no heating“.

GUPO 20 | 55 | 70 | 150 | 200

Burner output: 34 - 208 kW  
Mode of operation: single-stage

Electrical connection 10 A: 1/N/PE ~ 50 Hz 220 - 240 V  
Motor: 90 | 180 W | 250 W

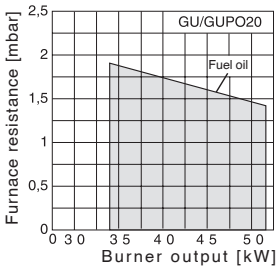

GUPO 20

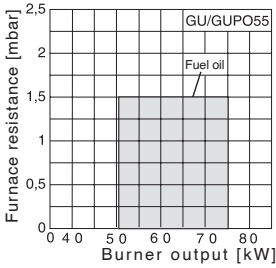
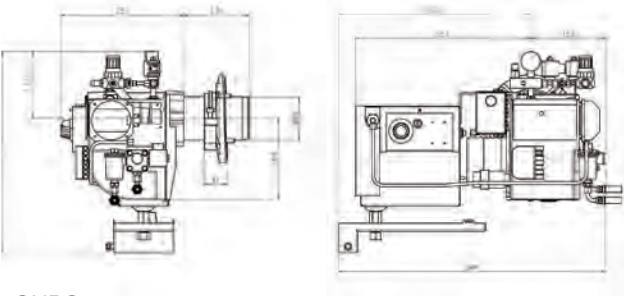

GUPO 55

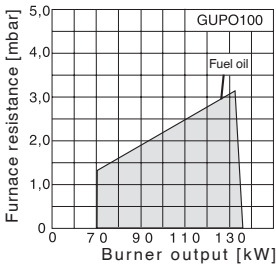
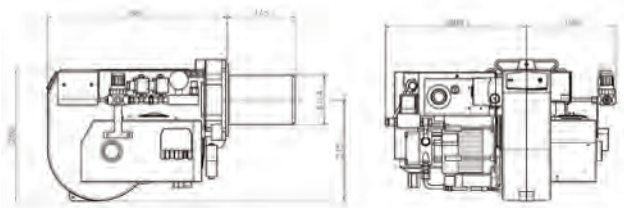

GUPO 100

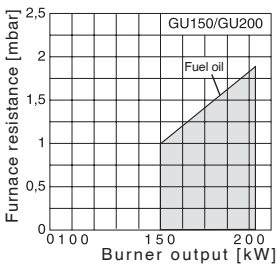
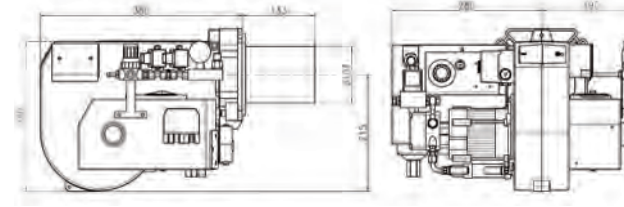

GUPO 200

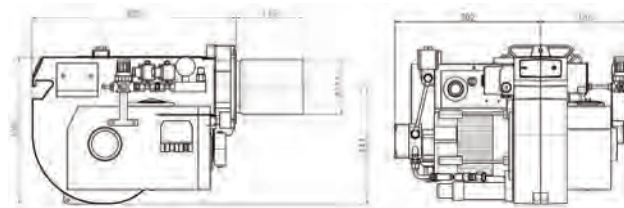

Oil burner  
Series R | GL | M | GUPO





**R1 | R20 | R30**

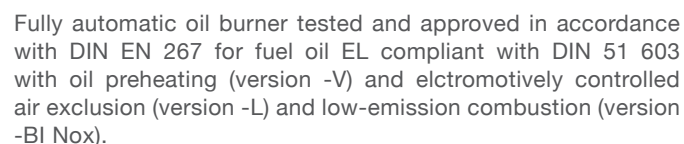

Equipped for two-stage output control (version -Z).  
Burner tube adjustable to combustion chamber depth. Burner assembly rotates around the burner tube axis. The burner can be mounted both horizontally or vertically.

Burner housing with baseplate and burner hood, integrated sound insulation and sliding flange, AC motor, high performance fan, mixing device and burner pipe, ignition transformer with twin electrode, two 1200 mm metal hoses and burner fastening material with flange seal.

Burner with control unit wired for connection and hydraulically, electrically and safety tested, 7-pin or 11-pin connection (version -Z) compliant with DIN 479.

**14 - 53 kW**  
Electrical connection 10 A: 1/N/PE ~ 50 Hz 220 - 240 V  
Motor: 90 W

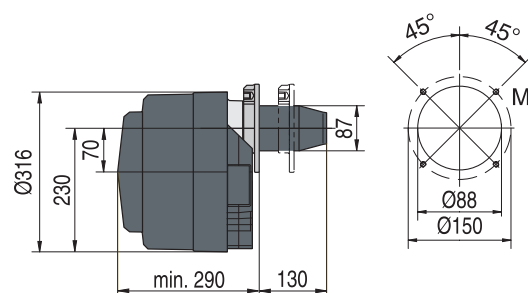

**33 - 166 kW**  
Electrical connection 10 A: 1/N/PE ~ 50 Hz 220 - 240 V  
Motor: 180 W

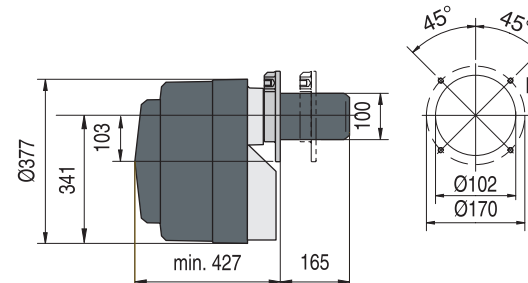

**95 - 273 kW**  
Electrical connection 10 A: 1/N/PE ~ 50 Hz 220 - 240 V  
Motor: 250 W

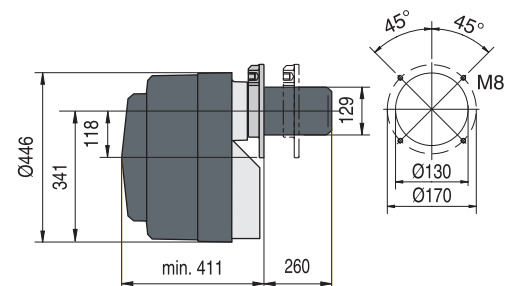
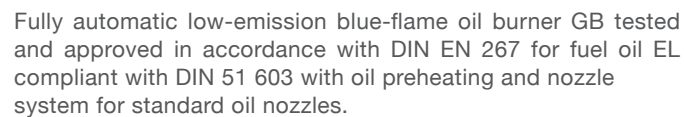
GL10-BiN<sub>o</sub>x | GL20-1/2-LN | GB 3000

Blue-flame burner with adjustable recirculation for NO<sub>x</sub> emissions < 120 mg/kWh in accordance with DIN 267. Burner tube is adjustable to combustion chamber depth. The burner can be mounted both horizontally or vertically.

Burner housing with baseplate and burner hood, integrated sound insulation and sliding flange, AC motor, high performance fan, mixing device, burner pipe, flame guard, ignition transformer with twin electrodes, two 1200 mm metal hoses and burner fastening material with flange seal.

**16 - 85 kW**  
Electrical connection 10 A: 1/N/PE ~ 50 Hz 220 - 240 V  
Motor: 90 W

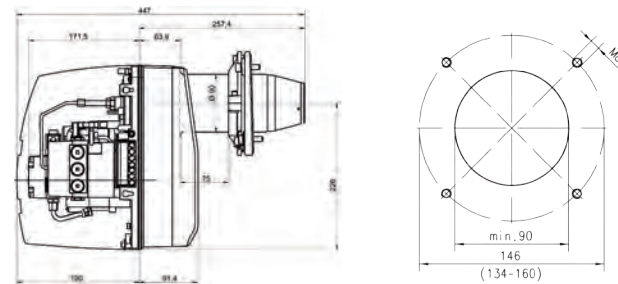

**44 - 216 kW**  
Electrical connection 10 A: 1/N/PE ~ 50 Hz 220 - 240 V  
Motor: 250 W / 370 W

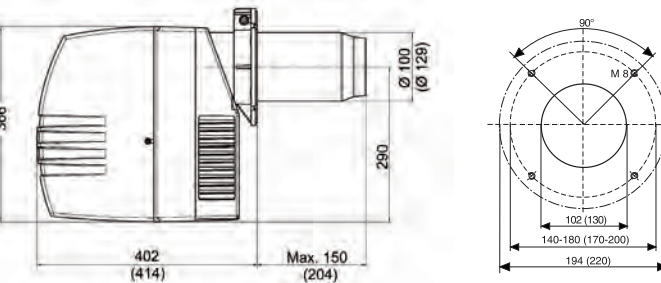

**15 - 50 kW**  
Electrical connection 10 A: 1/N/PE ~ 50 Hz 220 - 240 V  
Motor: 90 W

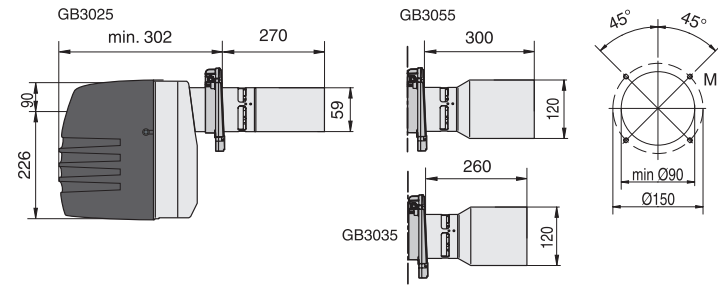

**M10-LN | M2-LN | M3-LN**

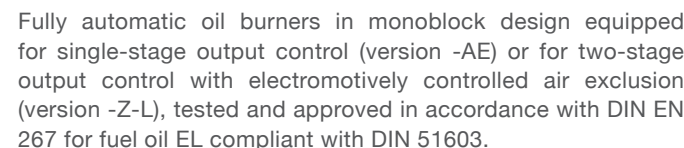

Silent, pressure-stable fan casting with sliding device for an easy and timesaving service. Burner housing with baseplate and burner hood, integrated silencer, AC motor, inner assembly with one or two nozzle system, two 1500 mm metal hoses and burner fastening material with flange seal. Burner with control unit wired for connection and hydraulically, electrically and safety tested, 7-pin or 11-pin connection compliant with DIN 4791.

**107 - 302 kW**  
Electrical connection 10 A: 1/N/PE ~ 50 Hz 230 V  
Motor: 370 / 750 W

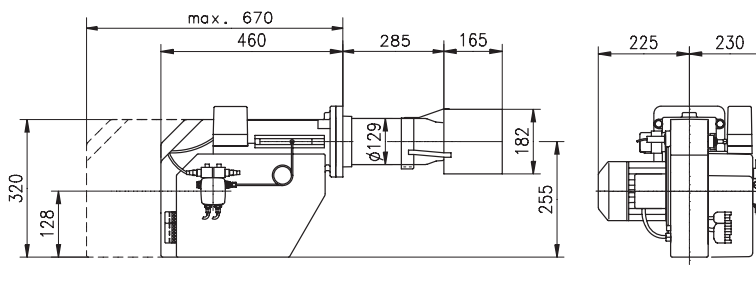

**171 - 534 kW**  
Electrical connection 10 A: 3/N/PE ~ 50 Hz 400 V  
Motor: 1.1 kW

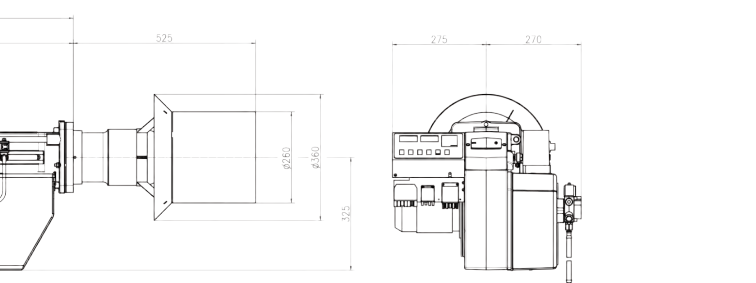

**351 - 918 kW**  
Electrical connection 10 A: 3/N/PE ~ 50 Hz 400 V  
Motor: 3.0 kW

