

VF 06

Filling valve for closed heating systems

Product specification sheet

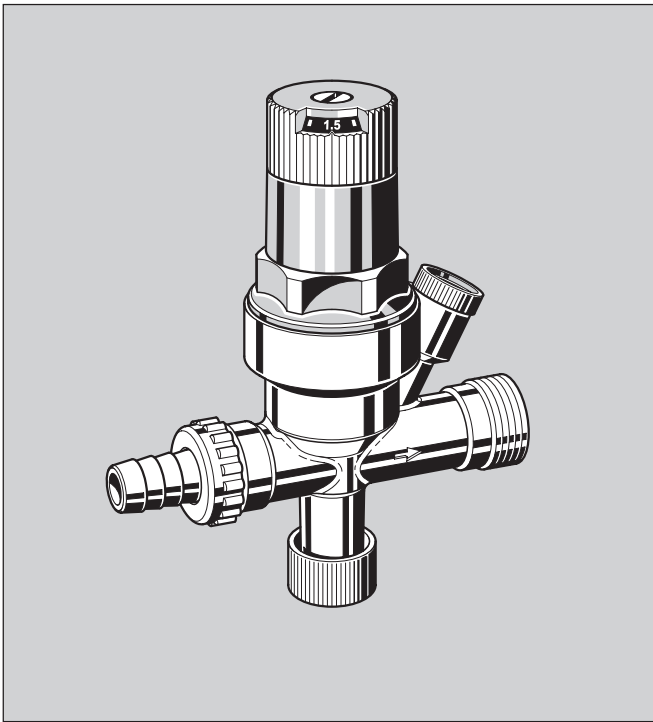

Construction

The filling valve comprises:

- Housing
- Spring bonnet with setting scale
- Spring
- Pressure reducing valve
- Non return valve cartridge
- Shutoff insert with knurled knob

Materials

- Brass housing
- High grade, heat resistant synthetic material spring bonnet
- Springsteel spring
- High grade, heat resistant synthetic material non return valve cartridge
- Fibre-reinforced NBR diaphragm
- NBR seals

Application

The VF 06 filling valve permit simple and safe filling or refilling of a closed heating system.

A pressure reducing valve, a check valve and a shutoff facility are combined in one unit. The pressure gauge connection enables fitting of a pressure gauge (available as an accessory) to provide accurate checking of the pressure of a system after filling.

Special Features

- Housing with internal and external threads
- One turn of the adjuster knob and the valve is set
- Setting directly readable on the adjuster knob
- Completly replaceable high grade synthetic material insert
- DIN/DVGW approved check valve
- Balanced-seat pressure reducing valve - inlet pressure fluctuations do not influence outlet pressure
- Integral shutoff facility
- Alternative connections

Range of Application

Closed heating systems to DIN 4751

Technical Data

Operating temperature	Maximum 70 °C
Inlet pressure	Maximum 16.0 bar
Outlet pressure	0.5 bar to 3.0 bar adjustable Set during manufacture to 1.5 bar
Connections	Inlet R ½" internal and R ¾" external threads Outlet R ½" internal and R ¾" external threads

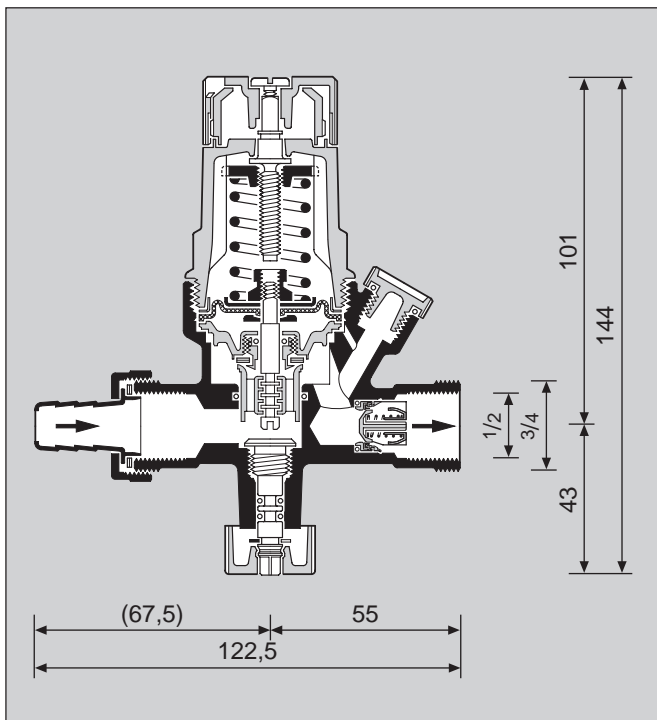

Method of Operation

The integral pressure reducing valve operates by means of a force equalising system. The force of a diaphragm operates against the force of an adjustment spring. The inlet pressure does not influence either opening or closing of the valve. Inlet pressure fluctuations do not therefore influence the outlet pressure, thus providing inlet pressure compensation. An integral check valve protects the drinking water supply by allowing water to pass through in only one direction. In the flow direction, a seal disc is pushed open against the force of a spring by differential pressure.

Options

VF 06 - 1/2 A = With hose union connector

VF 06 - 1/2 B = With threaded union connector

Accessories

MF 126 Pressure gauge

63 mm diameter. Connection tapping at bottom R 1/4", Range 0-4.0 bar, with red hand at 1.5 bar, red mark at 2.5 bar and green field between 1.5 and 2.5 bar

0903454 Hose connector union complete

With hose connector union, screw and gasket ring

VST 06-1/2 A Connection set

With threaded union connector, screw and gasket ring

ZR 06 K Double ring wrench

For removal of the spring bonnet

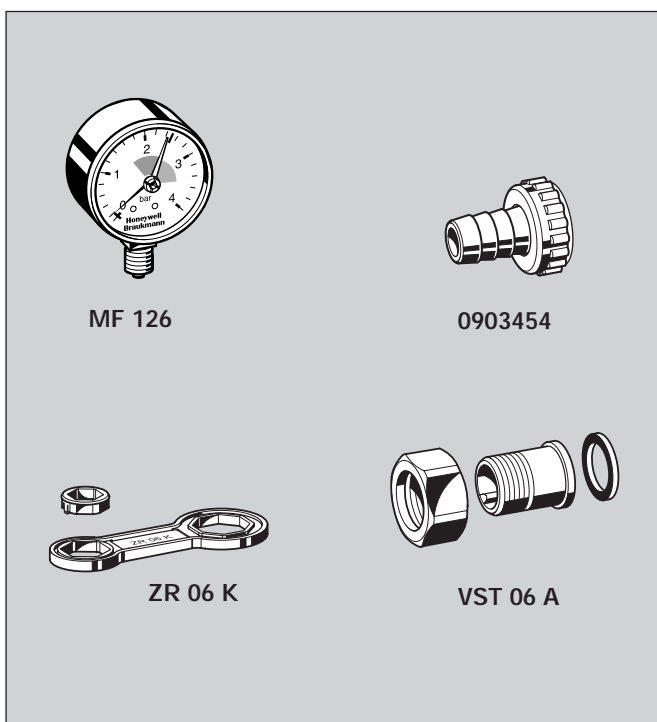

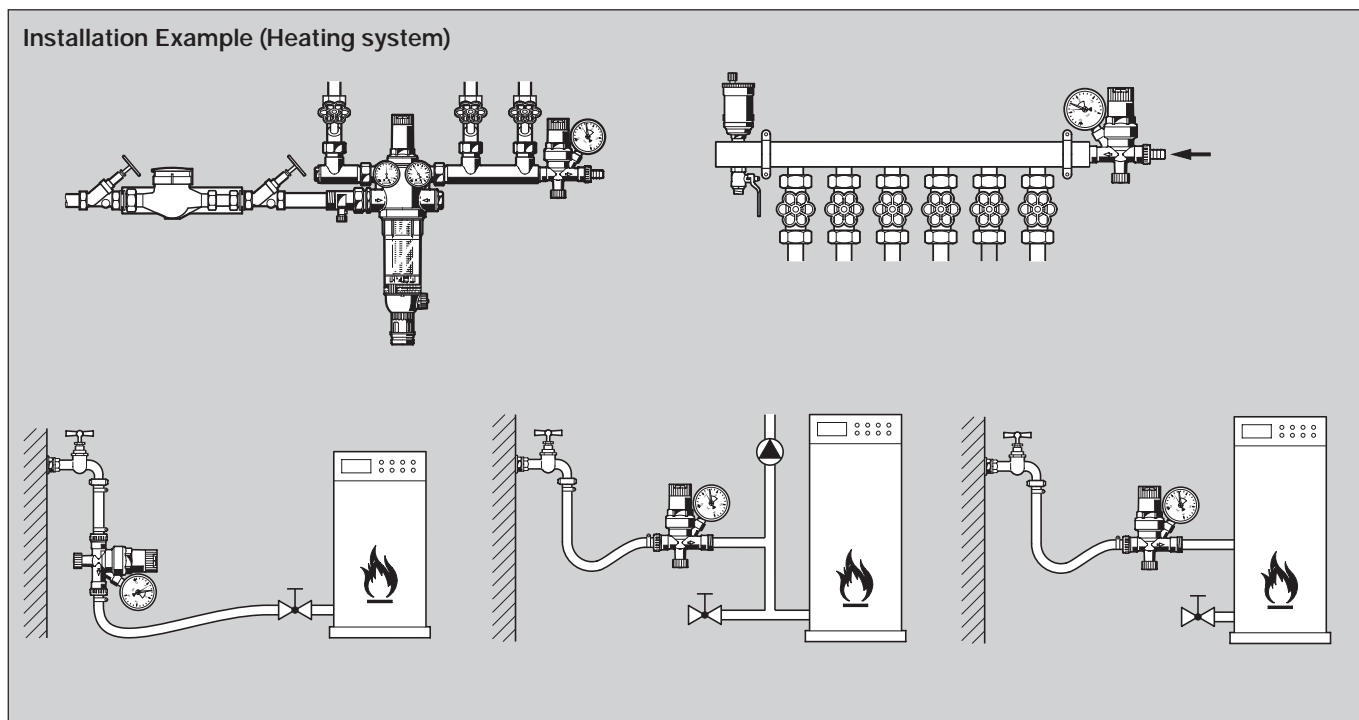

Installation Guidelines

- Set adjuster scale to system filling pressure required
- Disconnect hose connection from filling valve after filling
- Check system pressure after every filling or refilling
- Ensure good accessibility
 - Simplifies maintenance and inspection

Typical Applications

The VF 06 filling valve permit simple and safe filling or refilling of a closed heating system.

Filling valves can be installed:

- Onto a heating circuit distributor manifold
- In combination with a water supply distributor manifold
- On a heating boiler via a fill hose
- In the supply to a heating boiler
- Directly onto a heating boiler
- As a filling set for trouble-free and safe initial filling of a system

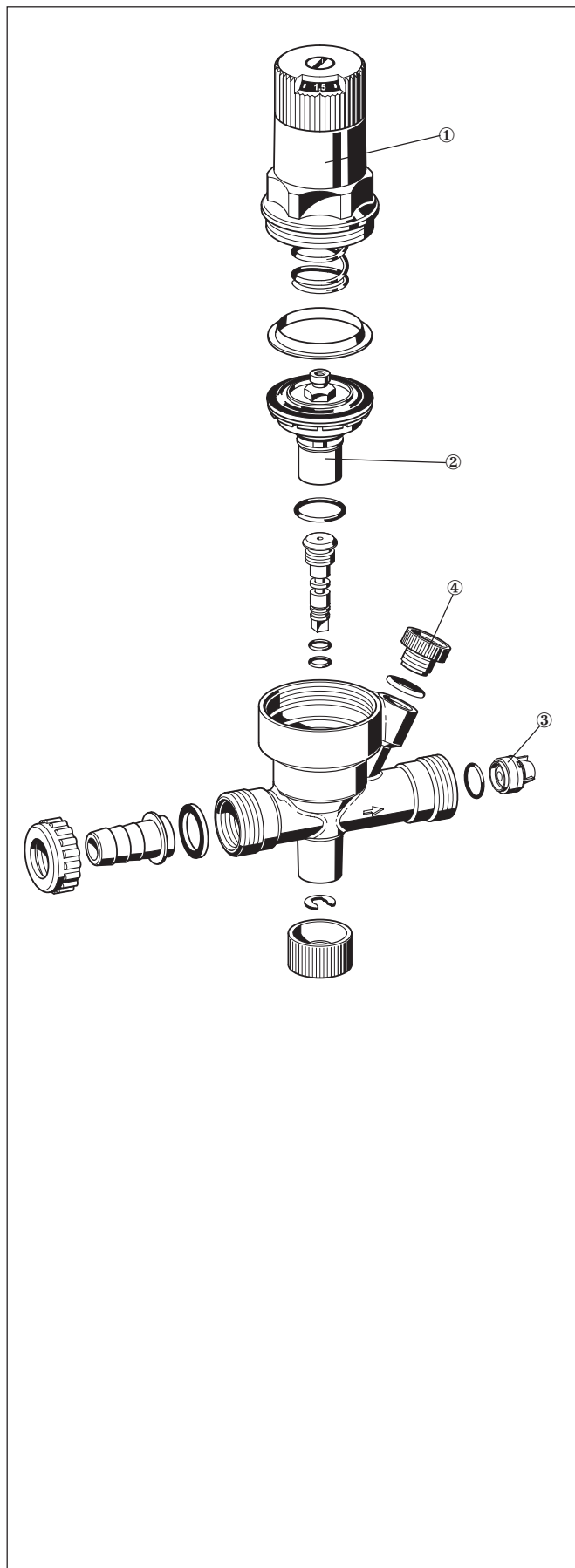
**Service Parts for VF 06 filling valves
1998 and after**

Description	Part Number
① Spring bonnet complete	0903445
② Valve insert complete	D 06 FA-1/2
③ Check valve	2166200
④ Blanking plug with 'O'ring (Pack of 5)	S 06 K -1/4

Subject to change 03/99

Honeywell**Braukmann Water Control** · Honeywell AG

P.O. Box 1347

D - 74819 Mosbach-Germany

Phone: (49) 62 61/ 0 62 61/8 10 · Fax: 0 62 61/8 13 09

<http://europe.hbc.honeywell.com>